

1 | 2 | 3 | 4 | 5 | 6 | 7 | 8

A

B

C

D

E

BILL OF MATERIALS			
NO.	Part Name	Materials	Materials
6	Bolt	A193 B8(M)	A193 B7(M)
5	Bonnet	A182 F316(L)	A105
4	Gasket	304SS+Graphite	304SS+Graphite
3	Spring	A276 304	A276 304
2	Disc	A182 F316(L)+STL	A276 420+STL
1	Body+Seat*	A182 F316(L)+STL	A105+STL

*: Seat integral

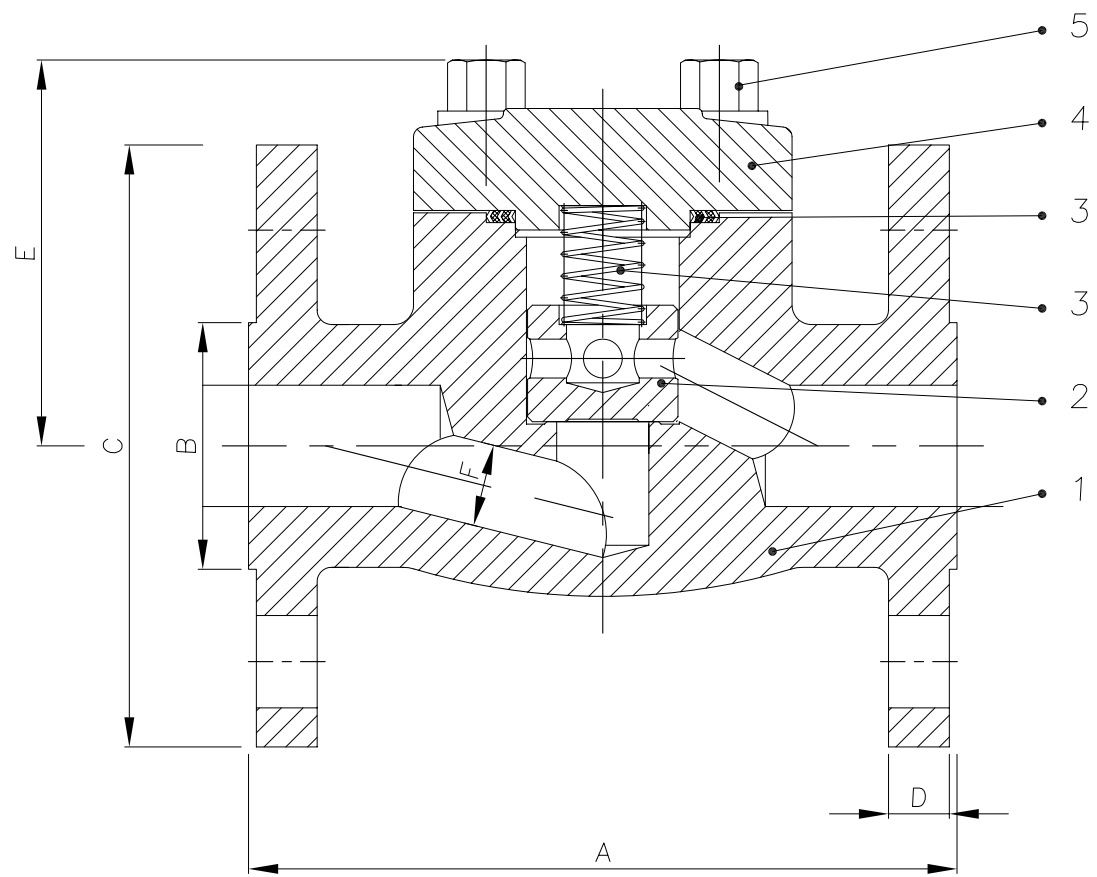

L · C · A · T · H · Q · W

NB	DN	A	B	C	D	E	F	G	Wgt	
60.3	1/2"	15	108	35	89	11.5	78	10	-	2.9
69.8	3/4"	20	117	43	99	13	81	13	-	3.2
79.4	1"	25	127	51	108	14.5	84	18	-	4.3
88.9	1 1/4"	32	140	63.5	117	16	98	23	-	5.8
98.4	1 1/2"	40	165	73	127	17.5	105	27	-	6.5
120.6	2"	50	203	92	152	19.5	124	33	-	14.5

Materials available on request: Stainless steel all grades; Duplex & Super Duplex; Chrome-moly; Inconel; Monel;

DESIGN CODE	API 602/ANSI B16.34	TEST PRESSURES		
FACE TO FACE DIMENSIONS	ANSI B 16.10	BODY	30.0	Barg
ENDS FLANGES DIMENSIONS	ASME B16.5	SEAT	22.0	Barg
TESTING CODE	API 598	BACKSEAT	22.0	Barg
		AIR - SEAT	6.0	Barg

REV	DATE	DESCRIPTION	BY	CHK	APP	SCALE:		
-	-	-				DRAWN	DM	DATE: 14/12/10
						CHECKED	SMN	DATE
						APPROVED	AW	DATE

DRAWING TITLE:
API FORGED, CLASS 150
BOLTED COVER, RF, PISTON CHECK VALVES

CLIENT: .

VENDOR PO REF: .

EVC REF: .

CAD. No. DRAWING NUMBER: 120183 REV 00

AREA No. | FACILITY | TYPE | SEQ. No. | SHT. No.

A

B

D

E

1 | 2 | 3 | 4 | 5 | 6 | 7 | 8